

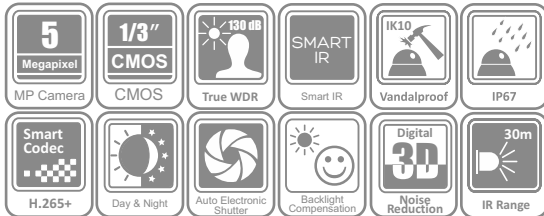

5MP IR Vandalproof Dome Camera

- 5MP (2560 x 1944) Video Output
- 2.8mm, F1.4 Fixed Lens
- 0.003 lux Low Light Illumination
- XPERT IR Illumination Range up to 30m
- True Day & Night Camera with ICR Filter
- 3D-Digital Noise Reduction (3D-DNR)
- 130 dB True Wide Dynamic Range (WDR)
- On-Screen Display (OSD) via Up the Coax (UTC)
- Ingress protection rated up to IP67
- Impact protection rated up to IK10



Dimensions

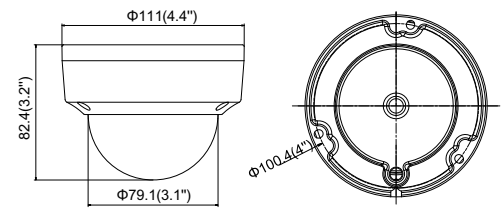

Technical Specifications

Model	TDP23W
Image Sensor	5MP Low Illum. Progressive Scan CMOS Sensor
Effective Pixels	2560 (H) x 1944 (V)
Min. Illumination	0.003lux (F1.2, AGC ON) / 0 lux with IR
Lens	2.8mm Wide Angle Fixed Lens
Day & Night	IR Illumination (30m), Mechanical ICR Filter
Image Processing	3D-Digital Noise Reduction (3D-DNR) 130 dB True Wide Dynamic Range (WDR) Mirror Smart IR Auto White Balance (AWB) Backlight Compensation (BLC) Automatic Gain Control (AGC)
Video Output	5MP (2560 x 1944)
Ingress Protection	IP67
Impact Protection	IK10
Power Requirements	12 VDC ± 25%; 5.8W max
Dimension	111(D) x 82.5 mm
Weight	0.5 kg